

PRYMA

IP67 BOXES FOR INDUSTRIAL SOCKETS

Description: IP67 SURFACE BOX 1x13 MOD. (TW)

Reference:

1712GM

Characteristics:

| | |
|---|--|
| Product type: | Boxes for industrial sockets |
| Exterior dimensions (Height x Width x Depth): | 504x297x177 mm |
| Dimensions of the flush-fit gap (HxWxD): | - |
| Number of modules: | 1x13 DIN rail |
| Installation: | Surface |
| Color: | Grey RAL 7035 |
| Window: | Transparent tinted window |
| Weight (Kg): | 2,76 |
| Cable entry: | - |
| Components: | - |
| Materials: | Halogen-free plastic materials. Frame and base: ABS. Transparent window: UV protection polycarbonate |

Technical data:

| | |
|----------------------------|-----------------------|
| Degree of protection: | IP67 |
| Resistance to impact: | IK08 |
| Glow wire resistance: | 650 °C |
| Ball pressure test: | 70 °C |
| Ambient temperature range: | -25 °C / +40 °C |
| Maximum operating voltage: | 1000 V AC / 1500 V DC |
| Double insulation: | Class II |

Certificates and standards:

| | |
|---------------|---|
| Directive: | 2014/35/EU |
| Standards: | UNE-EN 62208 and UNE-EN 61439-1 (as applicable) |
| Certificates: | |



Codes:

| | |
|------------------------|---------------|
| EAN: | 8431044102009 |
| Customs tariff number: | 85.38.10.00 |
| ETIM 6.0: | EC000379 |

PRYMA

IP67 BOXES FOR INDUSTRIAL SOCKETS

Description: IP67 SURFACE BOX 1x13 MOD. (TW)

Reference: 1712GM

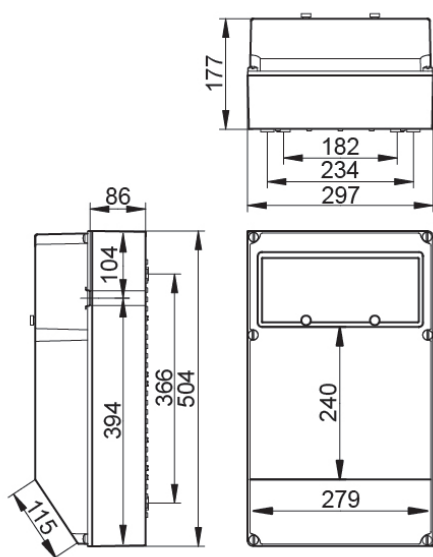

Detailed drawing:



<http://www.ide.es/downloads/planos/pdf/1712GM.pdf>



<http://www.ide.es/downloads/planos/dxf/1712GM.dxf>



<http://www.ide.es/downloads/planos/stp/1712GM.stp>

Exterior dimensions (Height x Width x Depth):

504x297x177 mm

Dimensions of the flush-fit gap (Height x Width x Depth):

-

Sustainability:

RoHS - REACH

Supply:

Supplied in individual cardboard packaging. When several items are sent together, they are bundled together with transparent film.

Packaging units: 2

Product end of life:

It does not require specific recycling operations.

Recommended applications:

Industrial and outdoor environments. Industrial sites, docks, swimming pools, garages, anywhere that requires a high degree of protection against dust, splashes and impacts.